

# MODEL VSU85-18

## 18 CUBIC FOOT ULTRA LOW TEMPERATURE FREEZER

	WIDTH	DEPTH	HEIGHT	WIDTH	DEPTH	HEIGHT
INTERIOR DIMENSIONS	23 IN	26 IN	51.25 IN	58 CM	66 CM	130 CM
EXTERIOR DIMENSIONS	36 IN	36 IN	79.5 IN	91 CM	91 CM	201 CM
CRATED DIMENSIONS	46 IN	43 IN	86 IN	116 CM	109 CM	218 CM

NOTE THAT SHELVES ARE SHOWN IN DEFAULT CONFIGURATION, AND CAN BE ADJUSTED IN 1" INCREMENTS

**SIDE VIEW**

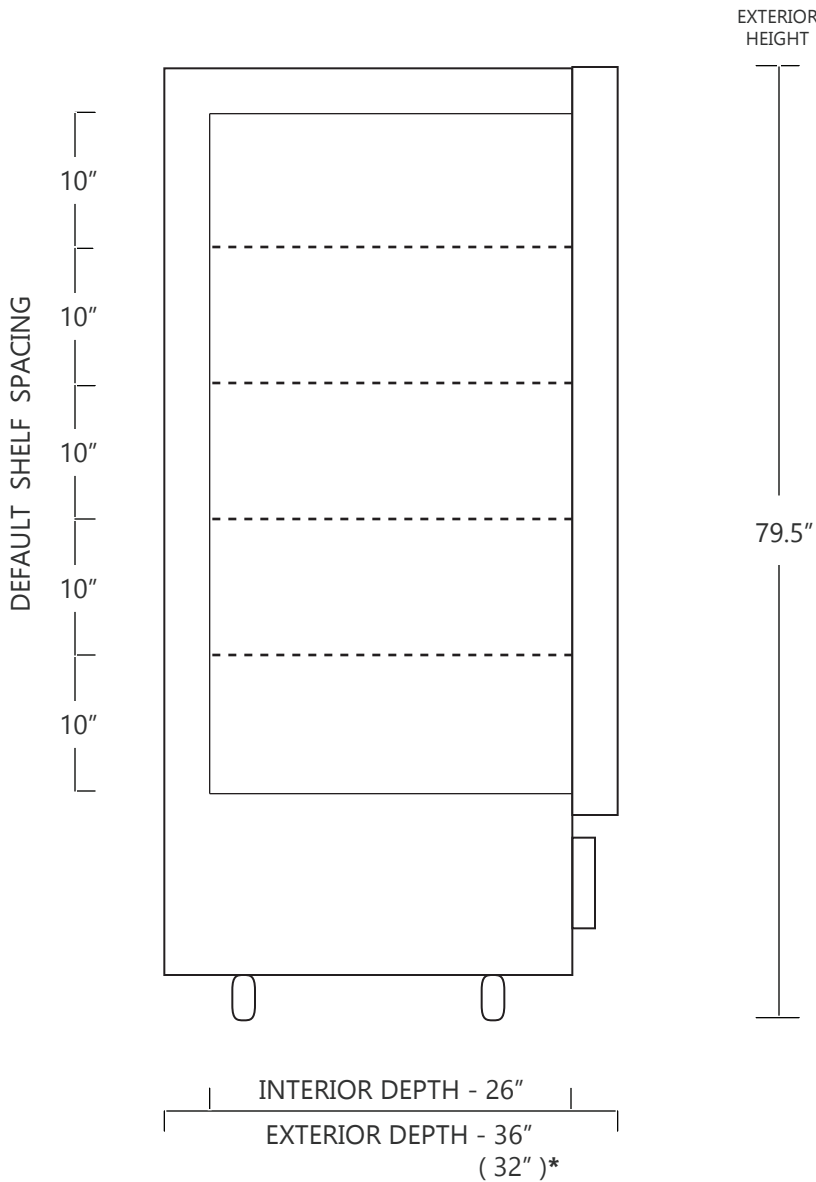

**FRONT VIEW**

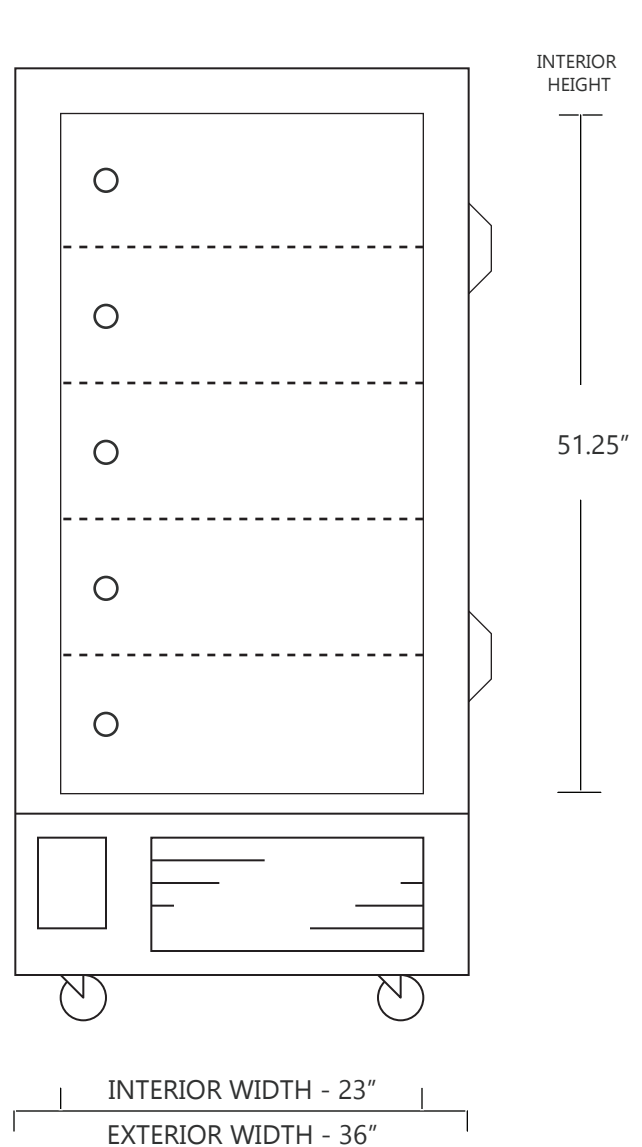

\*TO PASS THROUGH DOORWAYS, THE DOOR CAN OPEN A FULL 180°, TO REDUCE THE UNIT EXTERIOR DEPTH TO 32"

**SO-LOW**

[WWW.SO-LOW.COM](http://WWW.SO-LOW.COM)



**NET WEIGHT : 725 LBS.**  
**SHIPPING WEIGHT: 900 LBS.**

**SHIPPING OPTIONS**

- DOCK-TO-DOCK DELIVERY ( REQUIRES FORKLIFT OR PALLET JACK )
- DOCK-TO-DOCK DELIVERY WITH LIFTGATE ( REQUIRES FORKLIFT OR PALLET JACK )
- INSIDE DELIVERY ( WHITE GLOVE DELIVERY )